

pirmo aukšto planas

Antro aukšto plotas:  
13.29 m<sup>2</sup>

Bendras statinio plotas:  
76.05 m<sup>2</sup>

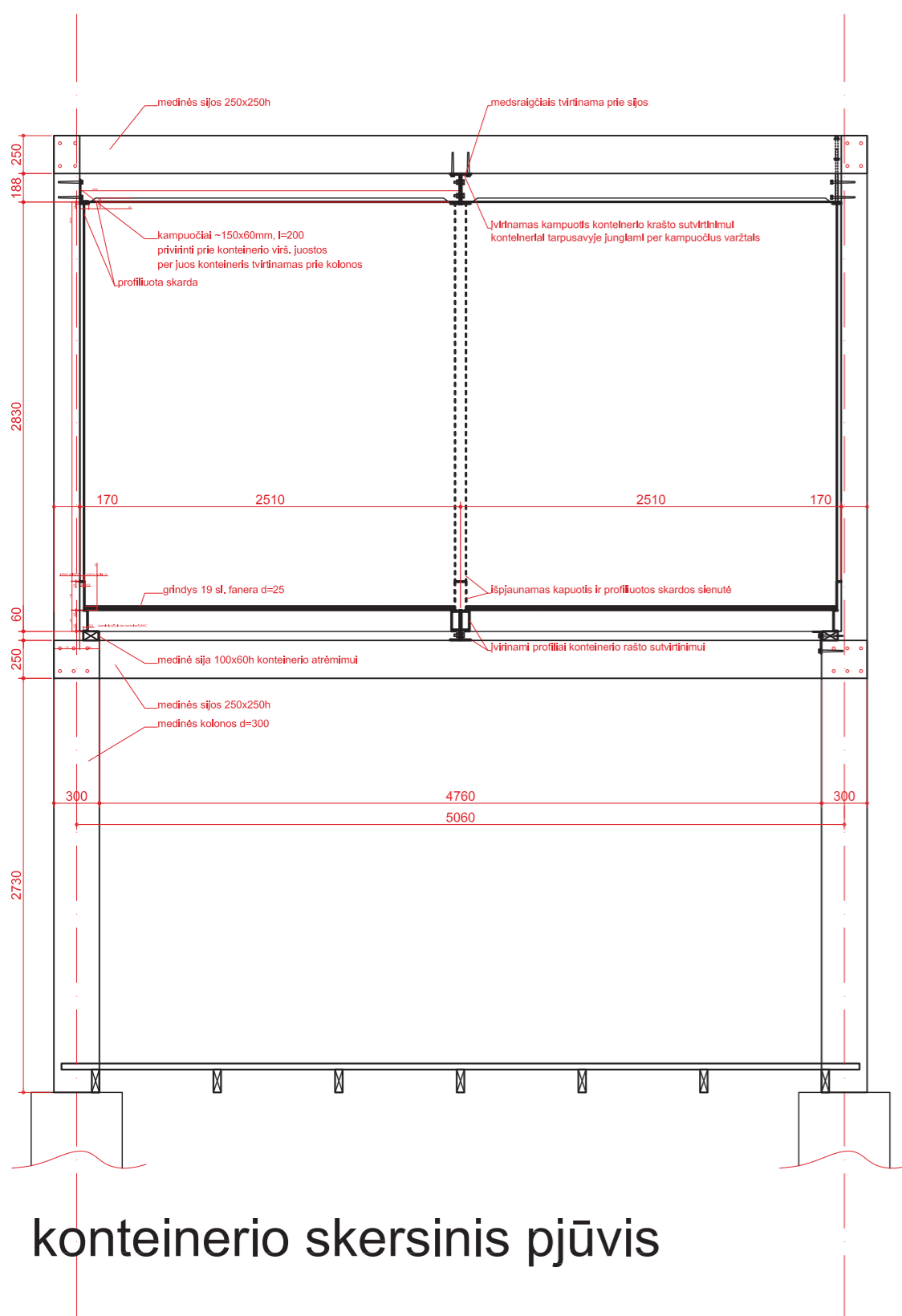

konteinerio skersinis pjūvis

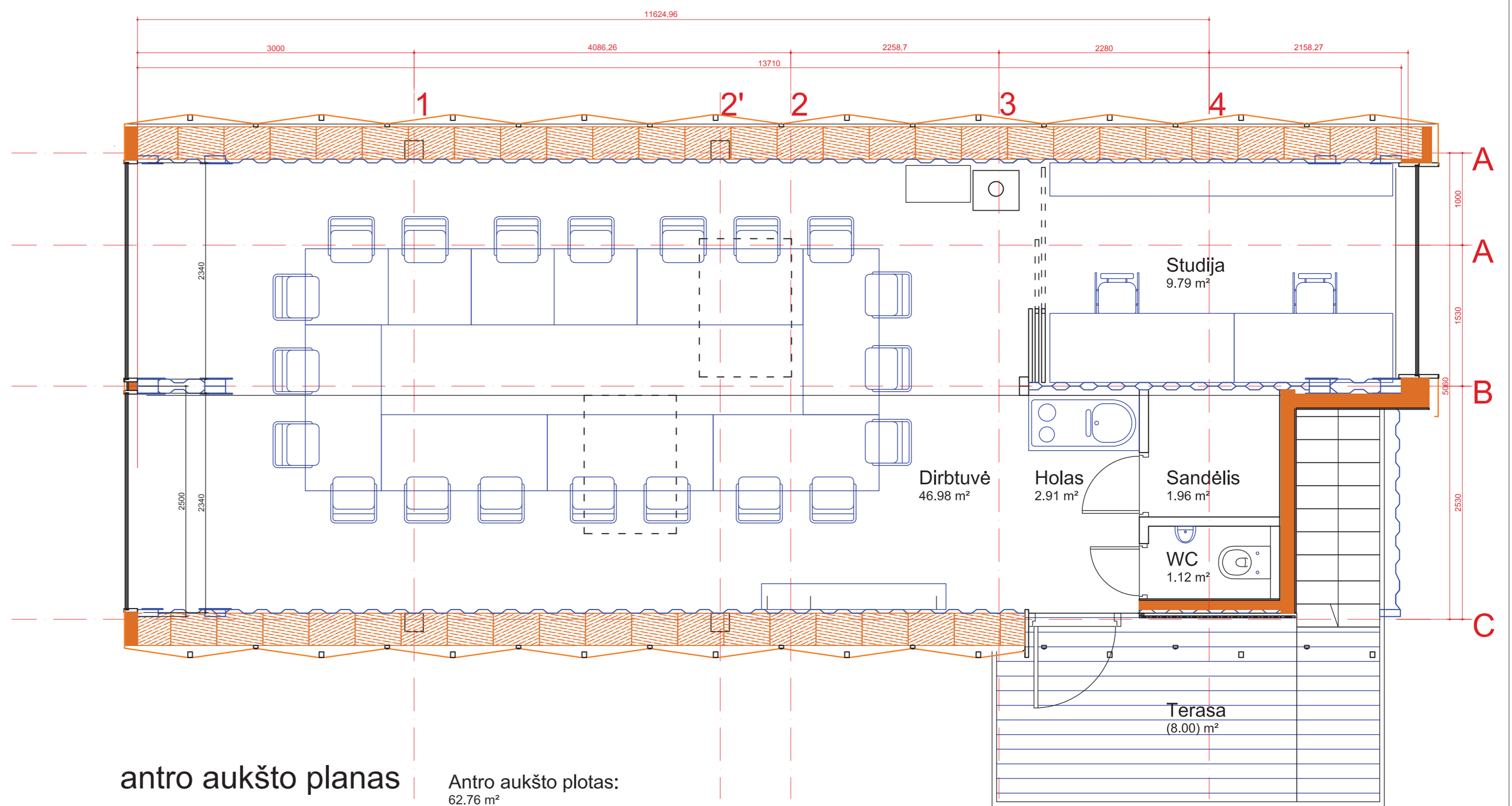

antro aukšto planas

Antro aukšto plotas:  
62.76 m<sup>2</sup>

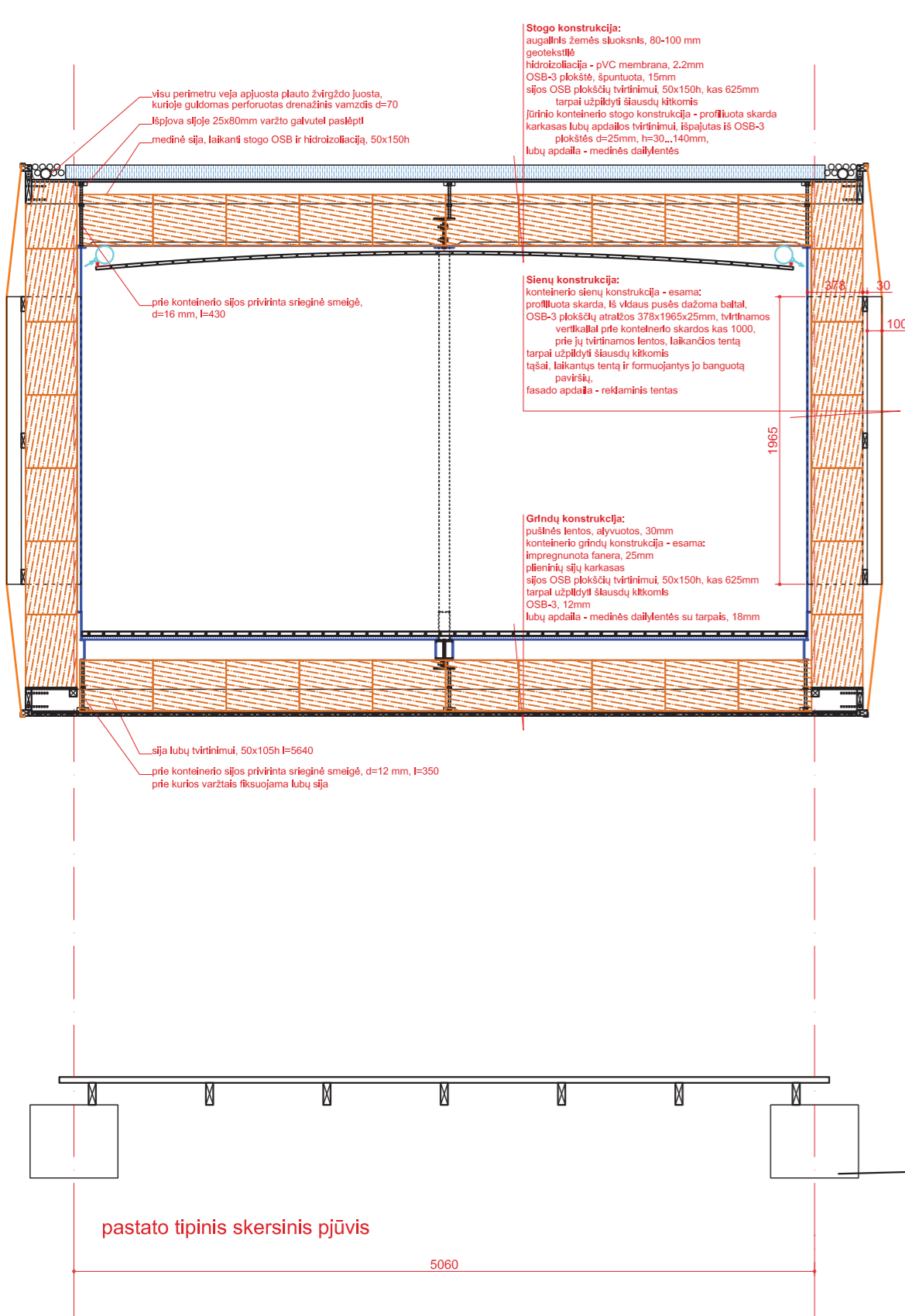

pastato skersinis pjūvis

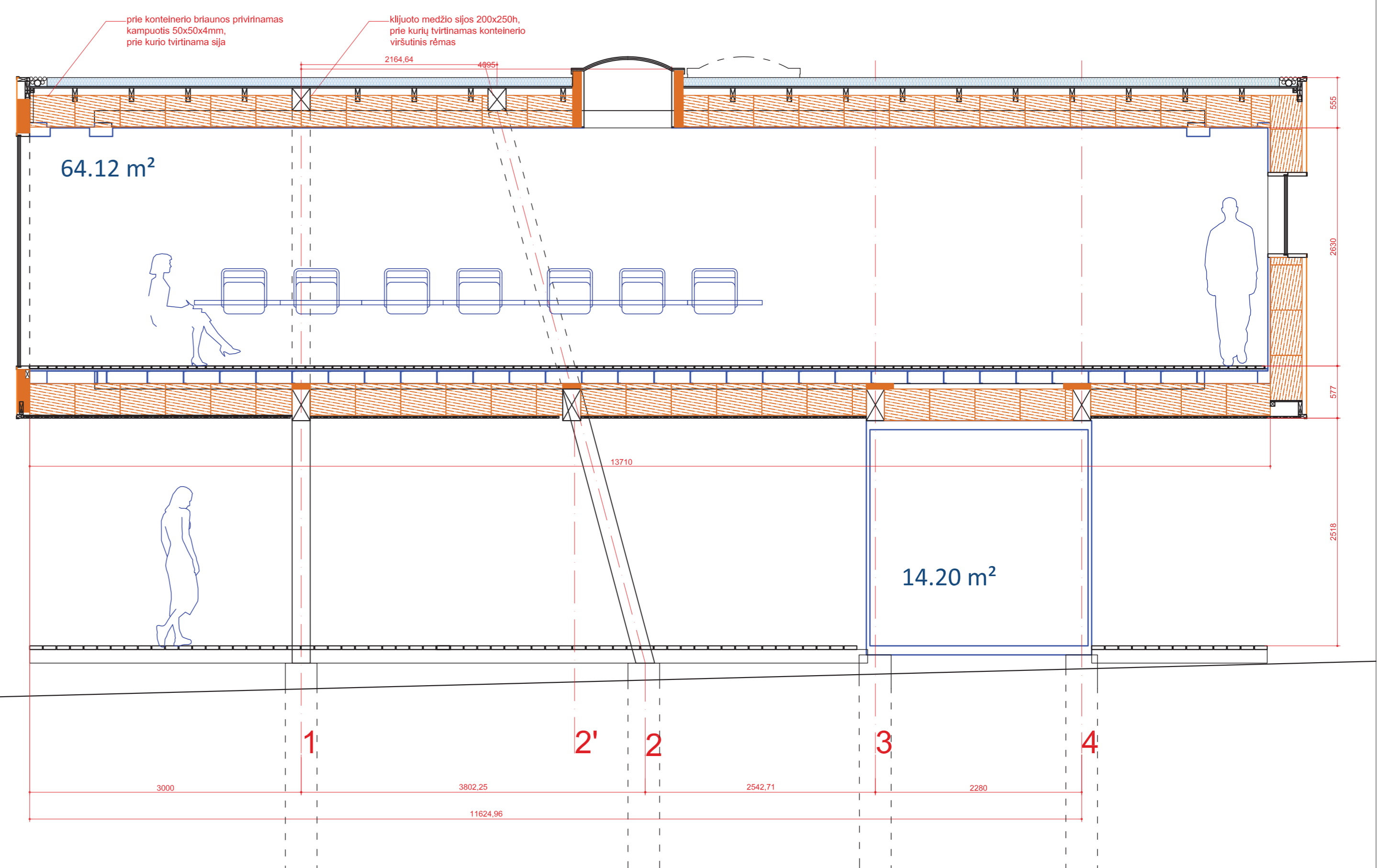

išilginis pjūvis